

Unit Information
230V - 50Hz - 340W

WARING
COMMERCIAL

Triple Head Drink Mixer
WDM360E / Europe

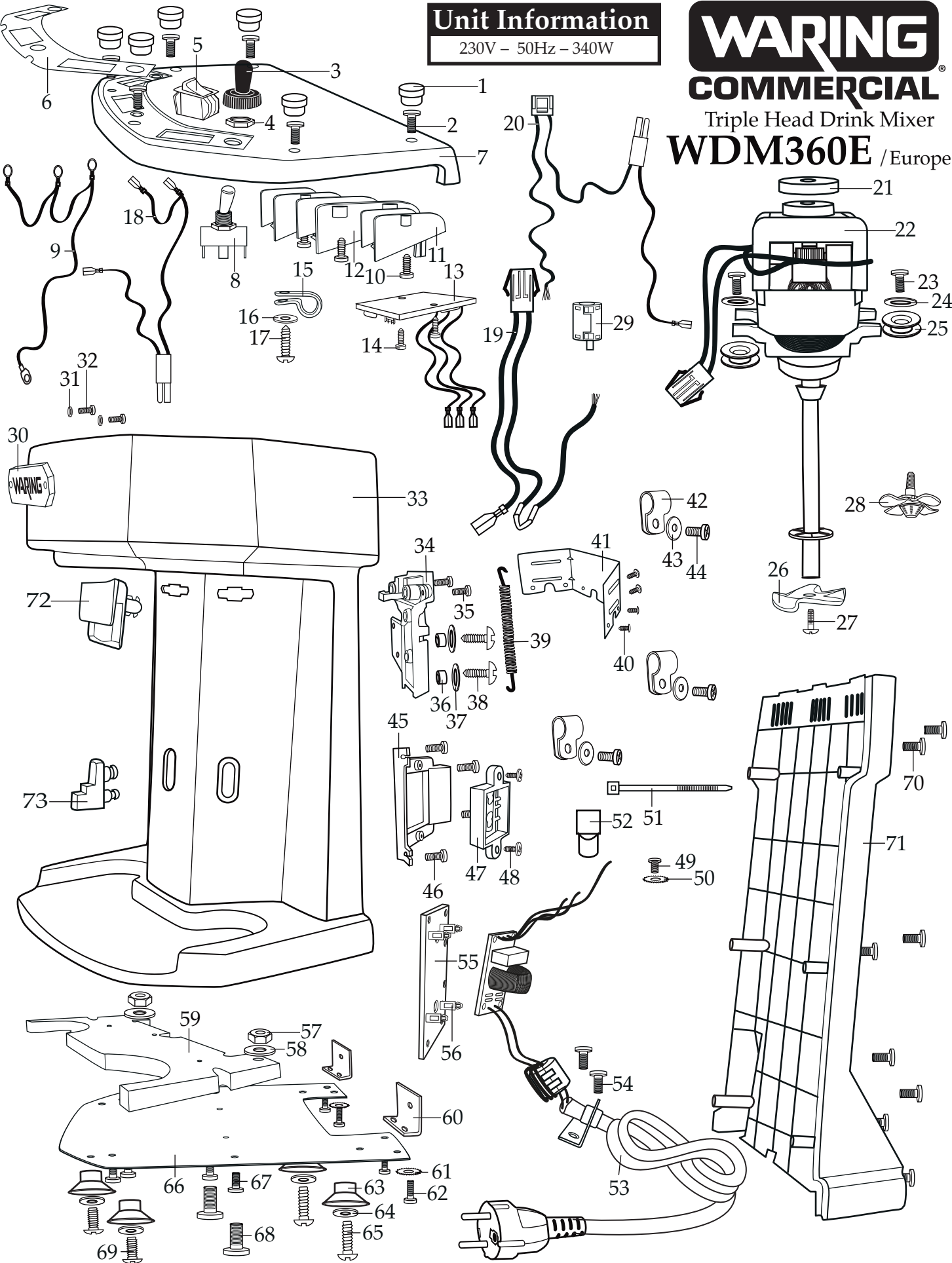
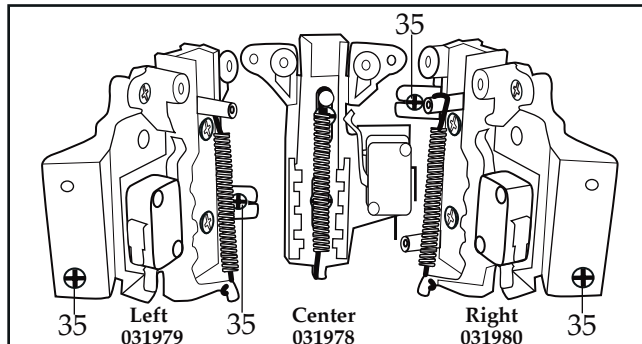
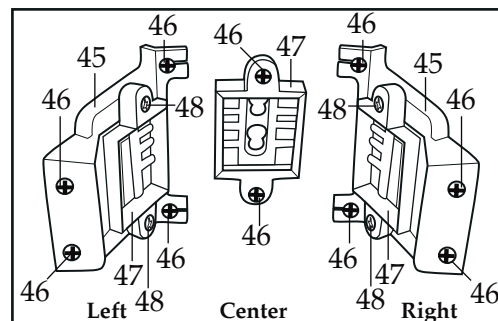

Illustration #	Part #	Description
1	030685	Rubber Hole Plug (6 required)
2	033901	Screw (6 required)
3	030682	Switch Boot (3 required)
4	016236	Hex Nut (3 required)
5	030683	Rocker Switch (3 required)
6	031975	Switch Plate
7	033883 033882	Top Housing Top Housing with PC Holders
8	034299	Toggle Switch (3 required)
9	033887	Ground Lead Harness
10	033886	Screw for PC Holders (5 required)
11	033884	Small PC Holder (2 required)
12	033885	Large PC Holder
13	033889	PC Board (3 required)
14	033890	PC Board Screw (2 required for each board)
15	030708	Cable Clamp for top housing (3 required)
16	030702	Washer (3 required)
17	033900	Screw for top housing cable clamp (3 required)
18	033888	Toggle Switch Black Harness (3 required)
19	033891	Black and Brown Lead Harness (3 required)
20	033892	Blue, White and Black Lead Harness (3 required)
21	030694	Top Motor Mount (3 required)
22	034304	Motor (3 required)
23	033968	Screw (2 required for each motor)
24	030696	Washer (2 required for each motor)
25	030697	Side Motor Mounts (2 required for each motor)
26	030716	Solid Agitator (3 required)
27	029291	Screw for solid agitator (3 required)
28	029292	Butterfly Agitator (3 required)
29	034302	Ferrite Core
30	030689	Name Plate Badge
31	030690	Name Plate Washer (2 required)
32	030691	Name Plate Screw (2 required)
33	031977	Front Housing

Illustration #	Part #	Description
34	031978 031979 031980	Center Actuator Switch Assembly (see View 2) Left Actuator Switch Assembly (see View 2) Right Actuator Switch Assembly (see View 2)
35	030700	Screw (2 required each Switch Assembly see View 2)
36	030703	Center Actuator Switch Assembly Sleeve (2 required)
37	030702	Center Actuator Switch Assembly Washer (2 required)
38	034976 030686	Center Actuator Switch Assembly Screw (2 required for right and left ONLY) Center Actuator Switch Assembly Screw (2 required for center)
39	030701	Spring (3 required)
40	031990	Actuator Retaining Bracket Screw (6 required)
41	031989	Actuator Retaining Bracket
42	030708	Cable Clamp (3 required)
43	030696	Washer (3 required)
44	030686	Screw (3 required)
45	031982	Left and Right Cup Support Locking Bracket (see View 3)
46	033901	Screw (4 required on both right and left brackets see View 3) (2 required center bracket see View 3)
47	030704	Cup Support Locking Assembly (3 required see View 3)
48	031981	Left and Right Locking Assembly Screw (2 required see View 3)
49	030706	Ground Screw
50	030707	Ground Lock Washer
51	013731	Wire Tie (6 required)
52	019123	Crimp Connector (2 required)
54	033901	Screw (2 required)
53	034305	Cord, PCBA, Bracket and Ferrite Core Assembly
55	034303	PCBA Holder
56	033881	Press Lock Stand-offs (4 required)



View 2
Looking into unit with back cover off at actuator switches with brackets.



View 3
Looking into unit with back cover off at cup holder brackets.

Illustration #	Part #	Description
57	033898	Back Foot Hex Nut (2 required)
58	033897	Back Foot Large Washer (2 required)
59	033896	Weight Plate
60	033895	Bottom Plate Bracket (2 required)
61	030707	Lock Washer (2 required for each bracket)
62	033969	Screw (2 required for each bracket)
63	030719	Foot (4 required)
64	030696	Foot Washer (4 required)
65	033894	Back Foot Screw (2 required)
66	031988	Bottom Plate
67	033901	Bottom Plate Screw (4 required)
68	033902	Weight Plate Screw (2 required)
69	031987	Front Foot Screw (2 required)
70	033901	Back Housing Screw (8 required)
71	031983	Back Housing
72	030717	Cup Actuator (3 required)
73	030718	Cup Support (3 required)

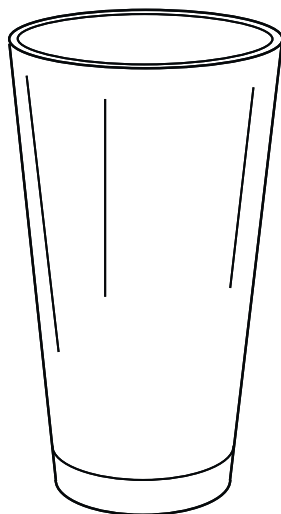

030883 Container
(3 required comes with unit)